

Infrared Touchless Actuator Switch

Experience a safer
and more open world

Utilising the latest in Active Infrared technology, the ASSA ABLOY Touchless actuators provide a totally contactless solution for door Egress, Access or Request to Exit applications. The Actuators provide both a Latching Output function along with an inbuilt timer for adjustable output times. Read range is also adjustable from 4 to 15cm, making the ASSA ABLOY Touchless actuators the ideal solution for use as a stand-alone product or integrated into any Access Control, Intercom, Keypad or Card Reader system.

Available in both Wall Plate and Architrave style designs, and IP65 Rated, the Touchless actuator switches are suitable for a host of environments and applications including sanitary requirements for facilities such as Hospitals, Aged and Health Care facilities, Medical Clinics and also high traffic areas including Offices and Universities.



Features & Benefits

- Timed or Latching Output Relay modes
- Adjustable Timed Output from 0.5 to 30 Seconds
- 25mm IR Sensor with adjustable read range from 40 to 150mm
- Available in both Wall Plate and Architrave Plate configurations
- NC & NO Output Relay
- 12 – 24VDC Operation
- Maximum current consumption – 21mA @ 12VDC
- Red & Green Bi-Colour LED Ring
- IP65 Rating for external applications
- Wall Plate model mounts onto a Single Gang Electrical Box

Specifications

Suitable for use as a stand-alone Touchless Actuator or integrated with any Access Control, Intercom, Keypad or Card Reader system.

Infrared Touchless Actuator Switch

Experience a safer
and more open world

Technical Information

Output	Toggle or Timed Output modes Timed Output adjustable – 0.5 to 30 seconds
Read Range	Adjustable – 4 to 15cm
Voltage	12-24VDC
Current @ 12VDC	Standby: 14mA Activation: 21mA
Environment	Weather resistant construction to IP65 Operating Temperature -10 to +70 Degrees Celsius
Endurance	Relay lifespan – 1,000,000 operations Infrared Sensor – 100,000 hours
Construction	Stainless Steel Plate and polycarbonate internals

Dimensions

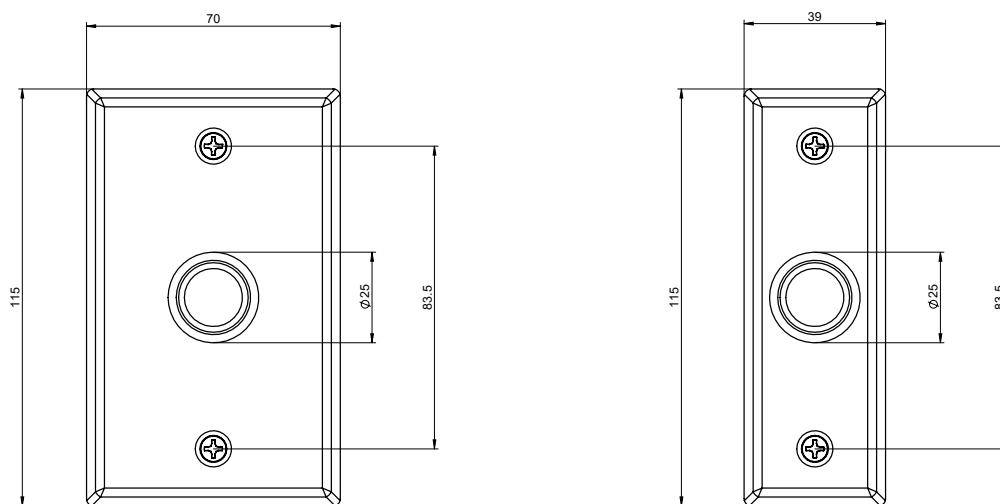

Specification Statement

The Door Egress or Request to Exit button shall be a Touchless unit with an adjustable read range of between 40 to 150mm and an operating output Relay that can be selected for latching or a timed operation of between 0.5 to 30 seconds. The button must operate on between 12 to 24VDC and have an IP Weather rating of no less than IP65. The actuators shall contain a Bi-Colour (Red/Greed) LED ring for indication of the output status.

Infrared Touchless Actuator Switch

Experience a safer
and more open world

Ordering

Part Number	Product Description
TLEG010	ASSA ABLOY Touchless Egress button, Stainless Steel, 25mm Sensor, Wall Plate style
TLEG020	ASSA ABLOY Touchless Egress button, Stainless Steel, 25mm Sensor, Architrave Plate style

Technology Partners

